

45X51-K-2.0

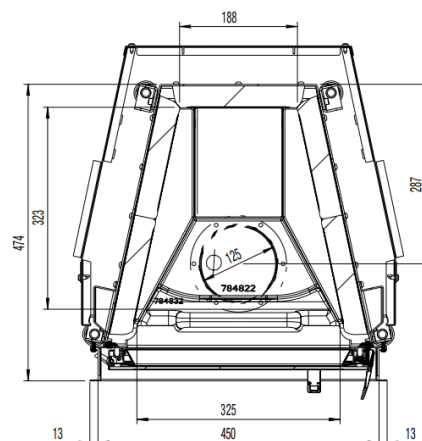

AUSTROFLAMM

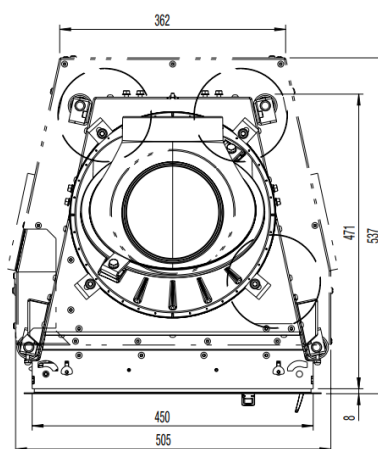
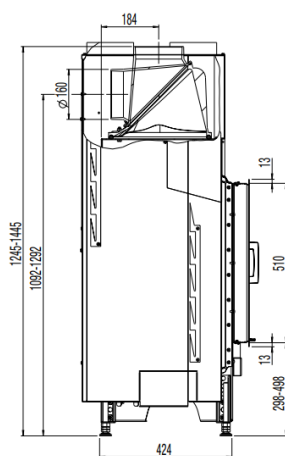
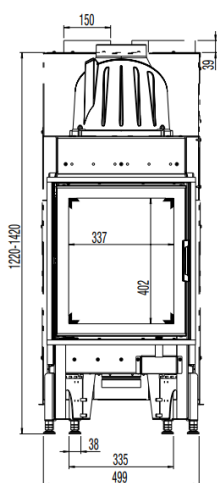

www.austroflamm.com

Dimensions and weight

| | |
|---|-----------|
| Height from [mm] | 1241 |
| Height to [mm] | 1441 |
| Width (body installation dimension) [mm] | 511 |
| Depth [mm] | 477 |
| Door frame height [mm] | 510 |
| Door frame width [mm] | 456 |
| Weight, basic appliance [kg] | 96 |
| Weight, HMS [kg] | 49 |
| Combustion chamber height [mm] | 450 |
| Combustion chamber width [mm] | 188 / 336 |
| Combustion chamber depth [mm] | 323 |
| Flue pipe outlet, diameter [mm] | 160 |
| Minimum distance to combustible materials - distance to rear dR [mm] | 0 |
| Minimum distance to combustible materials - left side dS_1 [mm] | 0 |
| Minimum distance to combustible materials - right side dS_2 [mm] | 0 |
| Minimum distance to adjacent combustible materials (e.g. furniture) dP [mm] | 1500 |
| Minimum distance to combustible materials - floor in front dF [mm] | 750 |
| Minimum distance to combustible materials - bottom dB [mm] | 0 |
| Minimum distance to combustible materials - left side radiation area dL_1 [mm] | 400 |
| Minimum distance to combustible materials - right side radiation area dL_2 [mm] | 400 |
| Minimum distance to combustible materials - distance to ceiling dC [mm] | 750 |
| Safety distance to insulation, ceiling [mm] | - |
| Safety distance to insulation, rear [mm] | 60 |
| Safety distance to insulation, left [mm] | 60 |
| Safety distance to insulation, right [mm] | 60 |
| Safety distance to insulation, floor [mm] | 0 |
| Insulation material thickness to installation base [mm] | 0 |
| Insulation material thickness to ceiling [mm] | - |
| Minimum distance from non-flammable materials [mm] | 50 |
| Insulation material, left [mm] | 100 |
| Insulation material thickness, right [mm] | 100 |
| Insulation material, rear [mm] | 100 |
| Cross-section, convection outlet [cm²] | 700 |
| Cross-section, convection inlet [cm²] | 700 |
| Max. amount of firewood fuel to be deposited [kg] | 1.7 |

Output

| | |
|---|-------|
| Nominal heat efficiency [kW] | 7.0 |
| Minimum heat output [kW] | - |
| Maximum heat output [kW] | 7.0 |
| Energy efficiency class | A |
| Circulating air cross-section with metal heat recovery surface [cm²] | 1000 |
| Circulating air cross-section without metal heat recovery surface [cm²] | 700 |
| Combustion air requirement [m³/h] | 26.88 |
| Minimum fuel throughput [kg/h] | - |
| Maximum fuel throughput [kg/h] | 2.1 |
| Outside air connection diameter [Ø mm] | 125 |

Equipment

| | |
|-------------------|---------|
| Hinged door | Yes |
| Sliding door | No |
| Double pane | No |
| Pane curvature | Flat |
| Opening mechanism | Folding |

- not available

Equipment

| | |
|--|-------------|
| Balanced flue - DiBt (German Institute for Structural Engineering) | - |
| Heat Memory System | Accessories |
| Hypocaust in compliance with technical regulations | Yes |

Data for the chimney sweep

| | |
|---|-----|
| Flue gas mass flow at nominal heat output [g/s] | 6.1 |
| Flue gas temperature [°C] | 314 |
| Minimum delivery pressure at nominal heat output [Pa] | 10 |